

Cable Termination

Open End Uninsulated Terminals

Materials:

Terminal body: Copper.
Plating: Bright electro tin.

Features:

Brazed seam.
Excellent corrosion resistance and conductivity.
Commonly used with cables carrying higher currents.

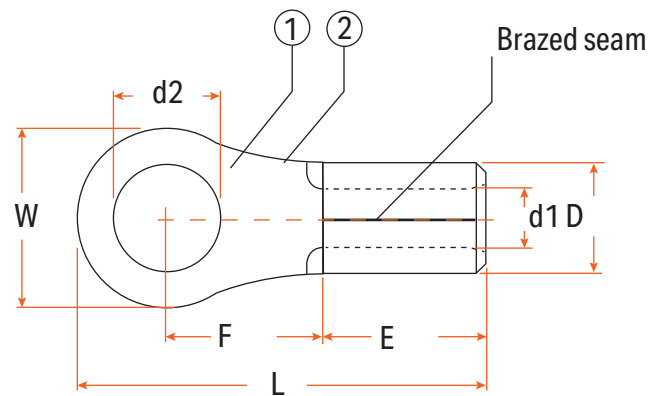

Material

- ① Copper
- ② Bright electro tin

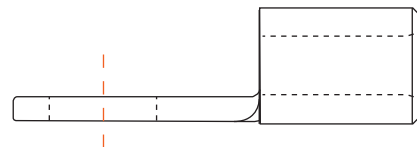

See product technical table on next page

Cable Termination

Open End Uninsulated Terminals

Item No.	Wire Range (mm ²)	Dimensions (mm)						
		D	d1	d2	W	L	E	F
RT10-6	6-10	7.2	4.5	6.6	12.0	23.8	8.5	9.3
RT10-8	6-10	7.2	4.5	8.5	15.0	29.8	8.5	13.8
RT10-10	6-10	7.2	4.5	10.6	15.0	29.8	8.5	13.8
RT16-6	10-16	9.0	5.8	6.6	12.0	29.8	10.5	13.3
RT16-8	10-16	9.0	5.8	8.5	16.0	32.5	10.5	14.2
RT16-10	10-16	9.0	5.8	10.6	22.0	32.5	10.5	14.2
RT16-12	10-16	9.0	5.8	13.0	16.5	41.0	10.5	19.8
RT25-6	16-25	11.5	7.7	6.6	16.5	33.5	12.0	13.5
RT25-8	16-25	11.5	7.7	8.5	16.5	33.5	12.0	13.5
RT25-10	16-25	11.5	7.7	10.6	16.5	33.5	12.0	13.5
RT25-12	16-25	11.5	7.7	13.0	22.0	42.5	12.0	19.7
RT35-6	35	13.3	9.4	6.6	22.0	42.7	14.0	17.7
RT35-8	35	13.3	9.4	8.5	22.0	42.7	14.0	17.7
RT35-10	35	13.3	9.4	10.6	22.0	42.7	14.0	17.7
RT35-12	35	13.3	9.4	13.0	22.0	42.7	14.0	17.7
RT50-8	50	15.4	11.4	8.5	22.0	49.7	18.0	20.7
RT50-10	50	15.4	11.4	10.6	22.0	49.7	18.0	20.7
RT50-12	50	15.4	11.4	13.0	22.0	49.7	18.0	20.7
RT70-8	70	17.5	13.3	8.5	24.0	50.0	18.0	20.0
RT70-10	70	17.5	13.3	10.6	24.0	50.0	18.0	20.0
RT70-12	70	17.5	13.3	13.0	24.0	50.0	18.0	20.0
RT95-10	95	22.1	16.4	8.5	28.5	55.6	21.0	20.4
RT95-12	95	22.1	16.4	10.6	32.0	55.6	21.0	20.4
RT95-14	95	22.1	16.4	13.0	32.0	69.0	21.0	32.0